

LED Leuchte mit Bewegungsmelder
 Led Lighting fixture with a movement sensor
 Светильник LED с датчиком движения

LED SMD



0,8W

50000

LED technology

MADE IN POLAND

APUS / TERRA / SABIK



APUS LED PIR



TERRA LED PIR



SABIK LED PIR

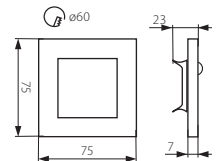

APUS LED

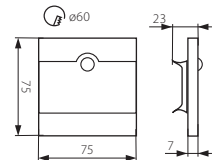

TERRA LED

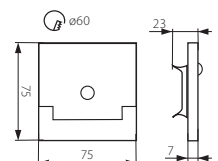

SABIK LED

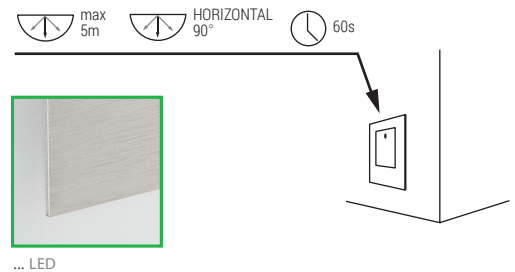
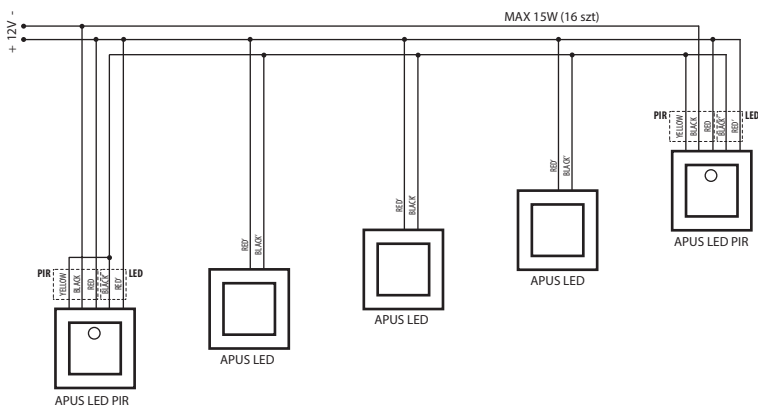
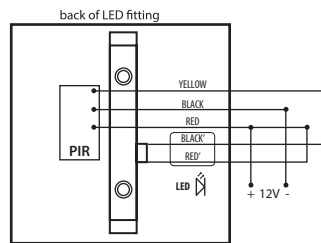

... LED

Kanlux



Tc [K]
 ELIPSE
 ≤ 6x MacAdam



APUS LED PIR CW	27371	6500	15	aluminium gebürstet / brushed aluminum / aluminium brossé
APUS LED PIR WW	27370	3000	13	aluminium gebürstet / brushed aluminum / aluminium brossé
TERRA LED PIR CW	27373	6500	15	aluminium gebürstet / brushed aluminum / aluminium brossé
TERRA LED PIR WW	27372	3000	13	aluminium gebürstet / brushed aluminum / aluminium brossé
SABIK LED PIR CW	27375	6500	15	aluminium gebürstet / brushed aluminum / aluminium brossé
SABIK LED PIR WW	27374	3000	13	aluminium gebürstet / brushed aluminum / aluminium brossé

- IP 20
- 12V DC
- III
- ≥20000
- EAC
- 5 x 0,5mm²
- 18 cm
- CE

Kanlux

A+, A, A, B, C, D, E

DE

Gehäuse: Edelstahl poliert

Geeignet für die Montage auf normal entflammablen Flächen

EN

casing: ground stainless steel

suitable for mounting on normally flammable surfaces

FR

boîtier : acier inoxydable rectifié

adapté pour un montage sur des surfaces normalement inflammables